

## Basement

The basement is comprised of five rooms (see Figure 6) with an overall interior measurement of 58x38 feet. All sections of the house have a basement except for that under the south section, which is unexcavated. Common basement elements include the dirt floor, stucco over stone walls, and exposed joists forming the ceiling. The north section is described first.

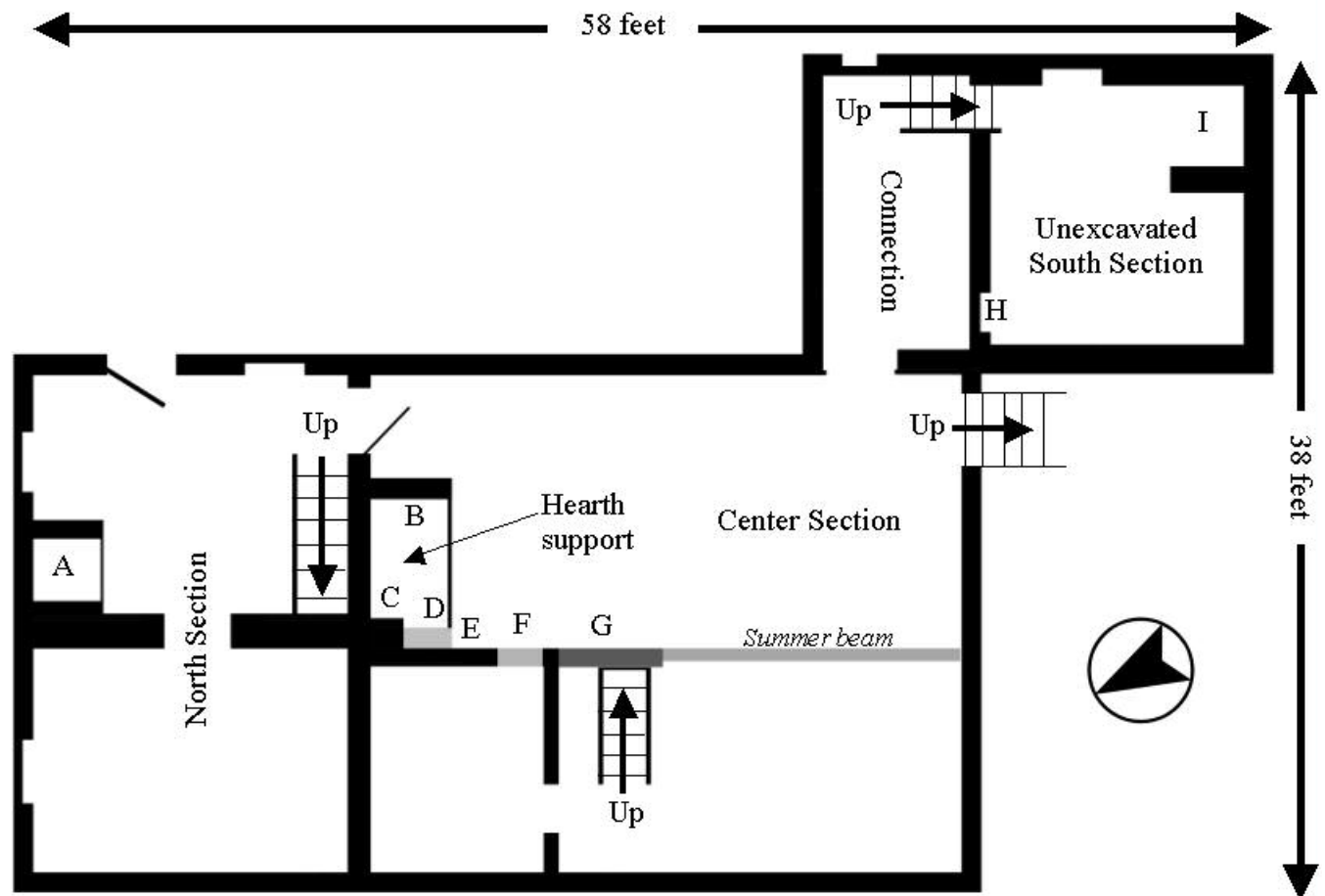

Figure 6. Floorplan of the basement. Lettered items are identified in the text.

The basement of the north section is divided into two rooms by a stone wall. A summer beam rests on the top of this stone wall, and the joists are connected to the summer beam with a mortise and tenon joint. Both rooms are finished, unlike the other parts of the basement. Portions of the wall in the room are paneled, the exposed joist ceiling is plastered, and a set of formal stairs is located along the south wall. The eastern room is dominated by the kitchen hearth in the northwest corner (indicated as “A” on the floorplan, Photo 31), with its mantle. The hearth has a molded wooden mantle with a large chamfered lintel. A doorway in the stone wall is the only means of egress into the room in the western portion of the north section.

The basement under the center section is a large rectangular space with a partitioned room occupying its northwest corner, as well as a large hearth support on the north wall. The original

door from the north section opens east of the hearth support (B), a large stucco over stone element consisting of piers supporting a stone arch below the original kitchen fireplace on the first floor. The portion of the hearth support facing the door has the “Hunsicker 1834” inscription (Photo 33). The western half of the hearth support’s arch has been removed (Photo 32) for an oil chimney made of brick (C), although the springstones for the arch remain in place. A furnace used to heat the house sat on a 2’x3’ cement pad and was vented through this brick chimney.



**Photo 31. Kitchen hearth in basement of north section, facing north.**

A stone wall extends south through the center of the basement of the center section. This stuccoed element appears to consist of a former freestanding pier at its southern terminus which has been extended to the north and abuts the south end of the western wall of the hearth support. [It has been suggested that it was part of the foundation of an earlier building on the location, but there is no evidence to support this argument.] A former passageway (F) between the pier and the hearth support, leading into the northwest room, was filled in, possibly using the stone removed from the hearth support.



**Photo 32. Altered fireplace hearth support in center section, showing the 20<sup>th</sup> century brick oil furnace flue.**

The original pier supported the center of the summer beam. Today, the northern half of the summer beam rests on the top of the stone wall. The thirteen exposed joists forming the ceiling of the basement of the center section are connected into the summer beam by a mortise and tenon joint. Several of these joists are chamfered at their intersection with the summer beam to accommodate a sill plate on the top of the stone wall.



**Photo 32a. Shaped joists rest on a sill plate on the top of the stone partition wall in the basement.**

On the southern end of the wall, a set of stairs leads to the first floor. North of the stairs is a soft brick wall with a door opening into the room in the northwest corner. This room may have been used as a cold cellar.

Two passageways are located near the southeastern corner of the larger room. The passageway on the southern wall leads into the bulkhead and up to the concrete porch on the south end of the center section. The second passageway leads to the Connection.

East of the bulkhead passageway is a doorway on the east wall leading into the basement of the connection (Photo 34). The basement under the connection measures 7'7" wide. Stairs along the east wall lead to the first floor, although markings on the walls indicate that the stairs formerly ran in the other direction (possibly when the flooring was replaced). A small window in the south wall near the southwestern corner (H) allows a view into the unexcavated area



**Photo 32b. Stone wall in basement of center section, showing the three sections south of the hearth support.**



**Photo 33. Markings on side of hearth support, reading "Hunsicker."**



**Photo 34. Entrance into connection, facing**

under the south section. This area is also visible through a small door on the east wall. The joists in the south section are in excellent condition; they appear to have replaced the original joists and floor system. What appears to be a hearth support (I) is located in the southeastern corner; when the chimney was removed, the stone was placed inside the hearth support, filling the space. Today an ash cleanout remains in this area, making evident that the original hearth was converted to a smaller coal stove unit probably when the floor was replaced.